

Makita[®]

40Vmax series

XGT

40V **Li-ion**
max





40V Li-ion max

High Power

Durability

**Digital
Communication**

Combination Hammer
HR001G / HR002G / HR003G / HR004G

Recipro Saw
JR001G

Impact Wrench
TW001G

Driver Drill
DF001G

Hammer Driver Drill
HP001G

Impact Driver
TD001G

Angle Grinder
GA003G / GA004G / GA005G /
GA011G / GA012G / GA013G

Circular Saw
HS003G / HS004G

Index

**4 — 40Vmax Li-ion Battery
40Vmax Fast Charger**

6 — Impact Driver
TD001G

**8 — Driver Drill
Hammer Driver Drill**
DF001G / HP001G

10 — Impact Wrench
TW001G

12 — Angle Grinder
GA003G / GA004G / GA005G
GA011G / GA012G / GA013G

14 — Combination Hammer
HR001G / HR002G / HR003G / HR004G

16 — Circular Saw
HS003G / HS004G

18 — Recipro Saw
JR001G





40V Li-ion max

Tool ◀▶ Battery ◀▶ Battery Charger
Digital communication

XGT is a new system with its own tools, batteries, and chargers. A combination of innovative tool design and higher output batteries provide a genuine solution for high demand industrial users.

Optimum power supply system and Optimum charging system

The XGT range of tools and batteries come with a built-in program, providing digital communication between the battery and tool. Allowing not only for the battery to talk with tool but also the tool to talk to the battery. Battery technology and motor engineering that work together for optimum performance.

Optimum charging system

Auto maintenance system with two cooling fans for providing more optimum fast charging

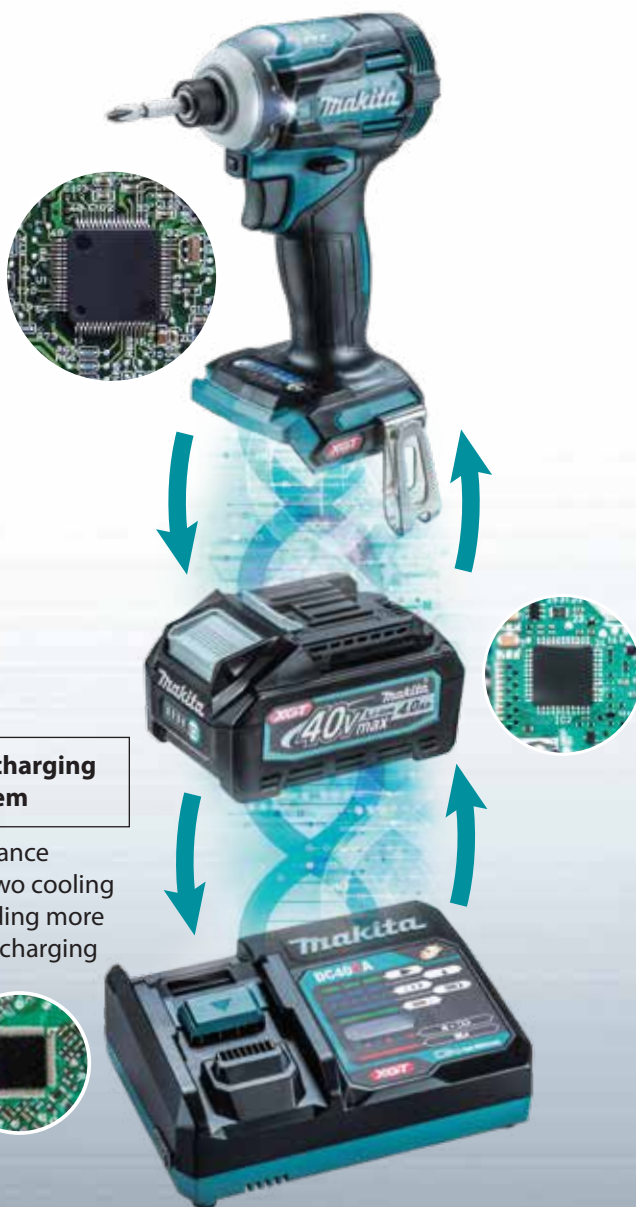

40Vmax Li-ion Battery

BL4025
2.5Ah
(191B36-3)



BL4040
4.0Ah
(191B26-6)



Charging time

BL4025	28 min
BL4040	45 min

40Vmax Lithium-ion Battery Series

Built Tough

High durability specifications specially designed for 40Vmax Li-Ion batteries

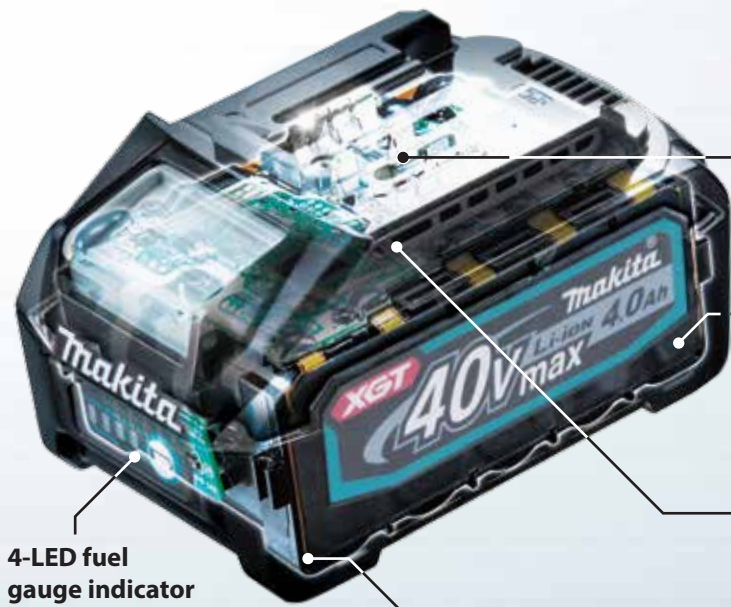

4-LED fuel gauge indicator

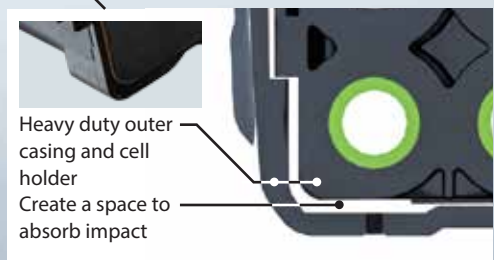

Heavy duty outer casing and cell holder
Create a space to absorb impact

Shock absorption structure

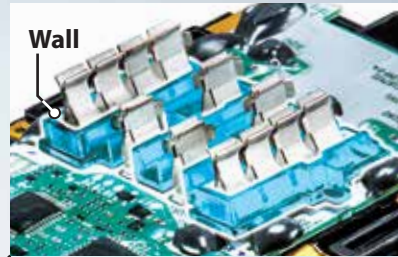

Terminal short-circuit prevention structure

The protection wall is provided between terminals against water and dust.

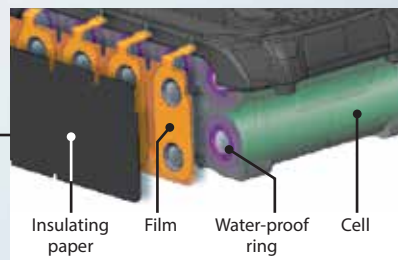

Waterproof Triple-layer Structure

prevents cell failure due to water and dust.

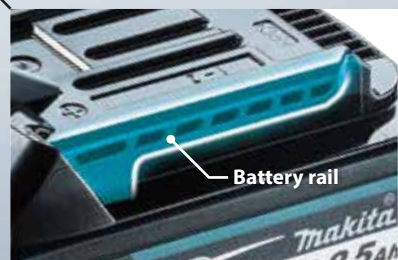

High Rigidity Battery Rails

Durable slide in battery rail that holds the battery and the tools firmly and securely to withstand high power products

40Vmax Fast Charger

The enlarged and raised LED light provides clearer indication of charging status.

DC40RA
(191E08-6)



Interchangeable Adapter

ADP10
(191C11-5)



Compatible with LXT Li-Ion batteries



**Impact Driver
TD001G**

Delivers 220N · m of Max Torque

10 Tightening modes

		No load speed / Impacts per min (min ⁻¹)	
<p>Wood mode driving at low speed until fastening begins</p> <p>0 - 1,800 / 4,400</p>	<p>3 Bolt mode with rotation auto stop for tightening/ loosening bolts for more efficient work</p> <p>Mode1: 2,500 / - Mode2: 3,700 / 4,400 Mode3: 3,700 / 4,400</p>	<p>T1 Teks screw (thin metal) Driving self-drilling screws to a thin gauge metal like a metal stud</p> <p>0 - 2,400 / -</p>	<p>T2 Teks screw (thick metal) Driving self-drilling screws to a thick gauge metal</p> <p>0 - 3,700 / 2,600</p>

4 -Speed power selection



6 -Assist modes

				No load speed / Impacts per min (min ⁻¹)			
<p>Max</p> <p>0 - 3,700 / 4,400</p>	<p>Hard</p> <p>0 - 3,200 / 3,600</p>	<p>Medium</p> <p>0 - 2,100 / 2,600</p>	<p>Soft</p> <p>0 - 1,100 / 1,100</p>	<p>Max</p> <p>0 - 3,700 / 4,400</p>	<p>Hard</p> <p>0 - 3,200 / 3,600</p>	<p>Medium</p> <p>0 - 2,100 / 2,600</p>	<p>Soft</p> <p>0 - 1,100 / 1,100</p>



BL MOTOR XPT

Rigid anvil holder with ball bearings reduces bit wobbling



about **15% UP**

Drove ø6.5 x 120mm metal fastening screws

TD001G	115	2.5s
Predecessor Model 18V	100	
Slow		Fast

One-touch bit installation



Variable speed control by trigger

Twin LED job light



- **One-touch 4-speed selector** provides precise fastening control for a wide range of applications.
- **Quick-change memory mode** allows operator to rapidly change between two registered setting

Work amount on a full battery charge*1

Battery: BL4025

about 800 pcs Drove 65mm coarse thread screws	about 160 pcs Drove 120mm metal fastening screws
---	--

Capacity	Machine Screw: M4 - M8 (5/32" - 5/16") Standard Bolt: M5 - M16 (3/16" - 5/8") High Strength Bolt: M5 - M14 (3/16" - 9/16") Coarse thread (in length): 22 - 125 mm (7/8" - 4-7/8")
Hex Shank	6.35 mm (1/4")
No Load Speed (RPM)	Max / Hard / Med / Soft: 0 - 3,700 / 3,200 / 2,100 / 1,100
Impacts Per Minute (IPM)	Max / Hard / Med / Soft: 0 - 4,400 / 3,600 / 2,600 / 1,100
Max Fastening Torque	220 N·m (1,950 in.lbs.)
Fastening Torque	Hard / Med / Soft: 170 / 50 / 20 N·m (1,510 / 440 / 180 in.lbs.)
Sound Pressure Level	96 dB(A)
Sound Power Level	107 dB(A)
Dimensions (L x W x H)	w/ BL4025: 120x86x245 mm (4-3/4"x3-3/8"x9-5/8") w/ BL4040: 120x86x250 mm (4-3/4"x3-3/8"x9-7/8")
Net weight	1.7 - 2.0 kg (3.7 - 4.4 lbs.)

*1 The test results depend to a great extent on the test material etc. **7**



Hammer Driver Drill / Driver Drill
HP001G / DF001G
13 mm (1/2")

Delivers 140N · m of Max Torque

Solid performance

especially in heavy duty applications by efficient brushless motor and XGT battery



41 electronical clutch setting (21-stage setting in High mode)

A wider range of torque can be covered than mechanical clutch



Easy jog dial adjustment with digital display

AFT Active Feedback sensing Technology

turns the motor off if bit rotation is suddenly forced to stop.



Drove ø8 x 400mm long construction screws into 400mm thick SPF

HP / DF001G	125
18V Predecessor Model	100

Slow Fast



Drilled holes through 38mm thick SPF with ø65mm (2 - 9/16") self-feeding bit

HP / DF001G	135
18V Predecessor Model	100

Slow Fast



photo: HP001G

BL MOTOR AFT XPT



HP001G

Mechanical 2-speed



DF001G

Compact overall length for easy handling and control

18V Predecessor Model



HP001G: 182mm

Work amount on a full battery charge*1

Battery: BL4025

about 40 pcs Drove ø8 x 400mm long construction screws into 400mm thick SPF	about 90 pcs Drilled holes through 38mm thick SPF with ø65mm (2 - 9/16") self-feeding bit	about 480 pcs Drilled holes through 38mm thick SPF with 7/8" Ship Auger bit
---	---	---

Outstanding drilling speed

0 - 2600 min⁻¹
at High speed mode

HP001G

Capacity	Steel: 20 mm (13/16") / Wood (Auger-Bit): 50 mm (2") Wood (Self-Feed Bit): 76 mm (3") / Wood (Hole Saw): 152 mm (6") Masonry: 20 mm (13/16")
Chuck Capacity	1.5 - 13 mm (1/16 - 1/2")
Impacts Per Minute (IPM)	High / Low: 0 - 39,000 / 0 - 9,750
No Load Speed (RPM)	High / Low: 0 - 2,600 / 0 - 650
Max Fastening Torque	Hard / Soft: 140 / 68 N-m (1,240 / 600 in.lbs.)
Max lock torque	125 N-m (1,100 in.lbs.)
Sound Pressure Level	85 dB(A)
Sound Power Level	96 dB(A)
Dimensions (L x W x H)	w/ BL4025: 182x86x275 mm (7-1/8"x3-3/8"x10-7/8") w/ BL4040: 182x86x282 mm (7-1/8"x3-3/8"x11-1/8")
Net weight	2.7 - 3.0 kg (6.0 - 6.6 lbs.)

DF001G

Capacity	Steel: 20 mm (13/16") Wood (Auger-Bit): 50 mm (2") / Wood (Self-Feed Bit): 76 mm (3") Wood (Hole Saw): 152 mm (6")
Chuck Capacity	1.5 - 13 mm (1/16 - 1/2")
No Load Speed (RPM)	High / Low: 0 - 2,600 / 0 - 650
Max Fastening Torque	Hard / Soft: 140 / 68 N-m (1,240 / 600 in.lbs.)
Max lock torque	125 N-m (1,100 in.lbs.)
Sound Pressure Level	75 dB(A)
Dimensions (L x W x H)	w/ BL4025: 181x86x275 mm (7-1/8"x3-3/8"x10-7/8") w/ BL4040: 181x86x282 mm (7-1/8"x3-3/8"x11-1/8")
Net weight	2.7 - 3.0 kg (5.9 - 6.6 lbs.)

*1 The test results depend to a great extent on the test material etc. **9**



Impact Wrench
TW001G
 3/4" (19 mm)

Over 2,000 N · m of Nut-Busting Torque

Electronic 4-stage impact power selection

enables user to control the power and speed depending on the applications.



Forward and reverse rotation auto stop mode



	Forward	Reverse
mode 1	Stops immediately after impact is detected	Stops immediately after the bolt/ nut gets loosened
mode 2	Stops approximately 0.5 seconds after impact is detected	Stops approximately 0.2 seconds after the bolt/ nut gets loosened
mode 3	Stops approximately 1 second after impact is detected	Shift to 230 min ⁻¹ after the bolt/ nut gets loosened

No load speed (min⁻¹)

- Max: 0-1,800
- Hard: 0-1,400
- Medium: 0-1,150
- Soft: 0-950

Impacts per minutes (min⁻¹)

- Max: 0-2,500
- Hard: 0-2,400
- Medium: 0-2,200
- Soft: 0-1,900



High power BL Motor





BL
MOTOR **XPT**



Twin LED job light



Full speed mode

Switches between variable and full speed by pressing the button. Reaches full speed with fewer pull trigger to minimize user's fatigue in continuous work.



Work amount on a full battery charge*1

Battery: BL4040

about **350 pcs**

Tightening M27 high strength bolts

Compact overall length for easy handling and control

← **217 mm** → TW001G

Predecessor
Model 18V



Fastening Capacities	Standard Bolt: M12 - M36 (1/2" - 1-7/16") High Strength Bolt: M10 - M27 (3/8" - 1-1/16")
Square Drive	19 mm (3/4")
No Load Speed (RPM)	Max / Hard / Med / Soft: 0 - 1,800 / 0 - 1,400 / 0 - 1,150 / 0 - 950
Impacts Per Minute (IPM)	Max / Hard / Med / Soft: 0 - 2,500 / 0 - 2,400 / 0 - 2,200 / 0 - 1,900
Max Fastening Torque	1,800 N·m (1,330 ft.lbs.)
Dimensions (L x W x H)	w/ BL4025: 217x94x297 mm (8-1/2"x3-11/16"x11-3/4") w/ BL4040: 217x94x303 mm (8-1/2"x3-11/16"x11-7/8")
Net weight	3.9 - 4.2 kg (8.6 - 9.3 lbs.)

*1 The test results depend to a great extent on the test material etc. **11**



Angle Grinder

Slide switch: GA003G / GA004G / GA005G
 Paddle switch: GA011G / GA012G / GA013G
 100 mm (4") 115 mm (4-1/2") 125 mm (5")

Delivers same power as 1,000W corded grinders

High durability

- Large ball bearing supports the motor.
- New switch design to reduce contact weariness.

No load speed:
8,500 min.⁻¹

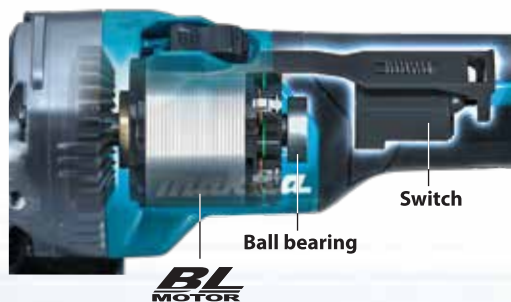

AFT Active Feedback sensing Technology

Shuts down the tool to protect the user, if the rotation speed suddenly slows down.

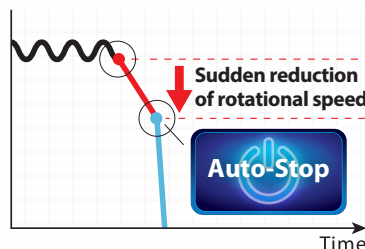

New toolless wheel cover

allows for fast and easy angle adjustment and installation / removal of wheel cover.

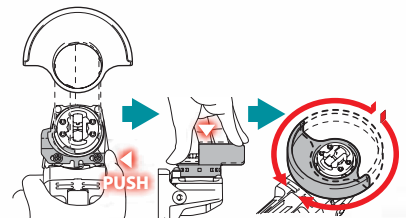

about
40% UP

Cut concrete at depths of 20mm

GA005G **140**

18V Predecessor Model **100**

Slow

Fast

Work amount on a full battery charge*1

Battery: BL4040

about **7m**

Cutting depths: 20mm

Accessories

Dust collection wheel guard

191F81-2

191G06-2





BL MOTOR AFT XPT



GA003G / GA004G / GA005G / GA011G / GA012G / GA013G

Slide Switch



GA005G

Paddle Switch



GA013G

Easy-to-hold slim grip

	Wheel Diameter	Switch	
GA003G	100 mm (4")	Slide	✓
GA004G	115 mm (4-1/2")		
GA005G	125 mm (5")		
GA011G	100 mm (4")	Paddle	✓
GA012G	115 mm (4-1/2")		
GA013G	125 mm (5")		

	GA003G	GA004G	GA005G
Wheel Diameter	100 mm (4")	115 mm (4-1/2")	125 mm (5")
Hole Diameter	16 mm (5/8")	22.23 mm (7/8")	22.23 mm (7/8")
No Load Speed (RPM)	8,500	8,500	8,500
Sound Pressure Level	81 dB(A)	81 dB(A)	81 dB(A)
Sound Power Level	92 dB(A)	92 dB(A)	92 dB(A)
Dimensions (L x W x H)	w/ BL4025: 398x117x150 mm (15-5/8"x4-5/8"x5-7/8")	w/ BL4025: 398x130x156 mm (15-5/8"x5-1/8"x6-1/8")	w/ BL4025: 398x140x156 mm (15-5/8"x5-1/2"x6-1/8")
	w/ BL4040: 410x117x162 mm (16-1/8"x4-5/8"x6-3/8")	w/ BL4040: 410x130x168 mm (16-1/8"x5-1/8"x6-5/8")	w/ BL4040: 410x140x168 mm (16-1/8"x5-1/2"x6-5/8")
Net weight	2.8 - 3.3 kg (6.2 - 7.3 lbs.)	2.9 - 3.5 kg (6.4 - 7.7 lbs.)	2.9 - 3.6 kg (6.4 - 7.9 lbs.)
	GA011G	GA012G	GA013G
Wheel Diameter	100 mm (4")	115 mm (4-1/2")	125 mm (5")
Hole Diameter	16 mm (5/8")	22.23 mm (7/8")	22.23 mm (7/8")
No Load Speed (RPM)	8,500	8,500	8,500
Sound Pressure Level	81 dB(A)	81 dB(A)	81 dB(A)
Sound Power Level	92 dB(A)	92 dB(A)	92 dB(A)
Dimensions (L x W x H)	w/ BL4025: 398x117x150 mm (15-5/8"x4-5/8"x5-7/8")	w/ BL4025: 398x130x156 mm (15-5/8"x5-1/8"x6-1/8")	w/ BL4025: 398x140x156 mm (15-5/8"x5-1/2"x6-1/8")
	w/ BL4040: 410x117x162 mm (16-1/8"x4-5/8"x6-3/8")	w/ BL4040: 410x130x168 mm (16-1/8"x5-1/8"x6-5/8")	w/ BL4040: 410x140x168 mm (16-1/8"x5-1/2"x6-5/8")
Net weight	2.8 - 3.4 kg (6.2 - 7.5 lbs.)	3.0 - 3.6 kg (6.6 - 7.9 lbs.)	3.0 - 3.6 kg (6.6 - 7.9 lbs.)

*1 The test results depend to a great extent on the test material etc. 13



Combination Hammer
HR001G / HR002G / HR003G / HR004G
28 mm (1-1/8")

AVT Anti Vibration Technology

Vibration Level
7.0 m/s²



AFT Active Feedback sensing Technology

turns the motor off if bit rotation is suddenly forced to stop.
(HR001G / HR002G)

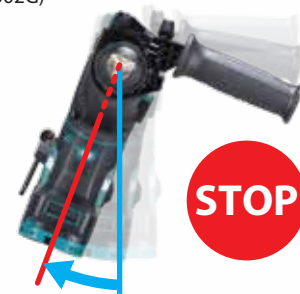

Redesigned Tool Balance for Increased Operability

The tool's center of gravity is located as close to the handle grip as possible, providing more control and less fatigue.

Lightweight
3.9 kg
Model: HR001G Battery: BL4025



AWS Auto-start Wireless System

connects to compatible vacuum cleaner with Bluetooth. The vacuum cleaner automatically runs while the switch is on.
(HR001G / HR002G)



Switch on the tool



Vacuum cleaner is activated





Work amount on a full battery charge*1
Battery: BL4025

about **120 pcs**

Drilled holes a depth of 60mm (2-3/8") with ø12.5mm bit

BL
MOTOR

AFT

HR001G / HR002G

AWS

HR001G / HR002G

AVT

SOFT
NO LOAD

HR001G / HR002G

XPT



Twin LED job light

Filter cleaning mechanism



Large dust box cover can be opened simply by pushing single push button for easy dust cleaning.



Quick change drill chuck (HR002G / HR004G)

Dust Extraction System

DX12 (191E52-3) / DX14 (191E58-1)



	Quick change drill chuck	AFT	AWS	Dust Extraction System
HR001G	—	✓	✓	DX12
HR002G	✓	✓	✓	DX14
HR003G	—	—	—	DX12
HR004G	✓	—	—	DX14

	HR001G / HR003G	HR002G / HR004G
Impact Energy	EPTA-Procedure 05/2009: 2.8 J	EPTA-Procedure 05/2009: 2.9 J
Capacity	Concrete / Steel / Wood / Core Bit / Diamond Core Bit (Dry Type): 28 / 13 / 32 / 54 / 65 mm (1-1/8" / 1/2" / 1-1/4" / 2-1/8" / 2-9/16")	Concrete / Steel / Wood / Core Bit / Diamond Core Bit (Dry Type): 28 / 13 / 32 / 54 / 65 mm (1-1/8" / 1/2" / 1-1/4" / 2-1/8" / 2-9/16")
Blows Per Minute (BPM)	0 - 5,000	0 - 5,000
No Load Speed (RPM)	0 - 980	0 - 980
Chuck Capacity	1.5 - 13 mm (1/16 - 1/2")	1.5 - 13 mm (1/16 - 1/2")
Sound Pressure Level	95 dB(A)	93 dB(A)
Sound Power Level	106 dB(A)	104 dB(A)
Dimensions (L x W x H)	w/ BL4025: 358x102x232 mm (14-1/8"x4"x9-1/8") w/ BL4040: 373x102x238 mm (14-3/4"x4"x9-3/8")	w/ BL4025: 389x102x232 mm (15-1/4"x4"x9-1/8") w/ BL4040: 404x102x238 mm (15-7/8"x4"x9-3/8")
Net weight	3.9 - 4.6 kg (8.6 - 10.1 lbs.)	HR002G: 4.1 - 4.6 kg (9.0 - 10.1 lbs.) HR004G: 4.0 - 4.5 kg (8.8 - 9.9 lbs.)

*1 The test results depend to a great extent on the test material etc. 15



photo: HS003G

Circular Saw
HS003G / HS004G
190 / 185 mm (7-1/2" / 7-1/4")

ADT Automatic torque Drive Technology

automatically changes the cutting speed according to load conditions for an optimum operation:

- On light duty: high-speed rotation mode
- On heavy duty: high torque mode

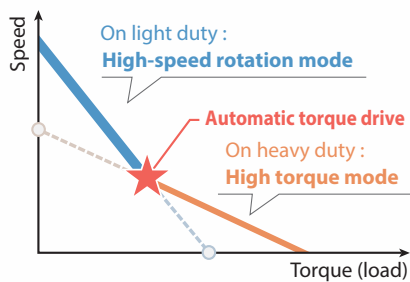

AWS Auto-start Wireless System



connects to compatible vacuum cleaner with Bluetooth. The vacuum cleaner automatically runs while the switch is on.



Bluetooth

Switch on the tool



Vacuum cleaner is activated

Compatible with guide rail without adapter (HS004G only)



Blower function



Twin LED Job light



Max. bevel capacity



Overload alert using driving mode lamp





photo: HS004G

BL MOTOR **ADT** **AWS** **(BRAKE)** **XPT**



photo: HS003G



photo: HS004G

Work amount on a full battery charge*1
Battery: BL4040

about **145 pcs**
Melapi
(thickness=60mm / width=300mm)

about **310 pcs**
SPF 2 x 10

Lightweight

4.4 kg
Model: HS003G
Battery: BL4040

Max cutting capacity at 90°

185mm 190mm
66 / 68.5 mm
Model: HS003G

Tool hanger
(optional accessory)



	HS003G	HS004G
Blade Diameter	190 / 185 mm (7-1/2" / 7-1/4")	190 / 185 mm (7-1/2" / 7-1/4")
Max Cutting Capacity	90°: 68.5 / 66 mm (2-11/16" / 2-5/8") 45°: 47.5 / 45.5 mm (1-7/8" / 1-13/16") 56°: 35.5 / 34 mm (1-3/8" / 1-5/16")	90°: 62.5 / 60 mm (2-7/16" / 2-3/8") 45°: 44.5 / 43 mm (1-3/4" / 1-11/16") 48°: 42 / 41 mm (1-5/8" / 1-5/8")
No Load Speed (RPM)	6,000	6,000
Dimensions (L x W x H)	w/ BL4025: 316x200x290 mm (12-1/2"x7-7/8"x11-3/8") w/ BL4040: 331x200x290 mm (13"x7-7/8"x11-3/8")	w/ BL4025: 322x210x290 mm (12-5/8"x8-1/4"x11-3/8") w/ BL4040: 337x210x290 mm (13-1/4"x8-1/4"x11-3/8")
Net weight	4.1 - 4.4 kg (9.0 - 9.7 lbs.)	4.4 - 4.7 kg (9.7 - 10.4 lbs.)

*1 The test results depend to a great extent on the test material etc. **17**



Recipro Saw
JR001G

High Durable Structure



Easy blade ejection lever



Smooth cutting with vertical crank system

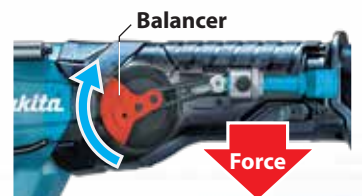

Tool-less shoe adjustment





BL MOTOR XPT

High Cutting Speed

Metal Cutting speed about **10% UP**

ø25.4mm (1") Carbon steel pipe

JR001G	110
18Vx2 Predecessor Model	100

Slow Fast

Wood Cutting speed about **35% UP**

SPF 2 x 10

JR001G	135
18Vx2 Predecessor Model	100

Slow Fast

Work amount on a full battery charge*1 Battery: BL4040	
about 130 pcs ø25.4mm (1") Carbon steel pipe	about 155 pcs SPF 2 x 10

Length of Stroke	32 mm (1-1/4")
Strokes Per Minute (SPM)	High / Low: 0 - 3,000 / 0 - 2,300
Capacity	Pipe : 130 mm (5-1/8") / Wood: 255 mm (10")
Sound Pressure Level	85 dB(A)
Sound Power Level	96 dB(A)
Dimensions (L x W x H)	w/ BL4025: 457x88x233 mm (18"x3-1/2"x9-1/8") w/ BL4040: 472x88x239 mm (18-5/8"x3-1/2"x9-3/8")
Net weight	4.2 - 4.5 kg (9.3 - 9.9 lbs.)

*1 The test results depend to a great extent on the test material etc. **19**



Lightweight
4.2 kg
Battery: BL4025





Makita Singapore Pte Ltd
7, Changi South Street 3, Singapore 486348
Phone : +65-6546-8700 Fax : +65-6546-8711
Email : msgproductteam@makita.com.sg
Website : www.makita.com.sg



f MakitaSG



Visit our website