



# Cordless Backpack Vacuum Cleaner

## DVC261 with Cleaner set / DVC265 AWS

### Accessories

#### For Cleaning

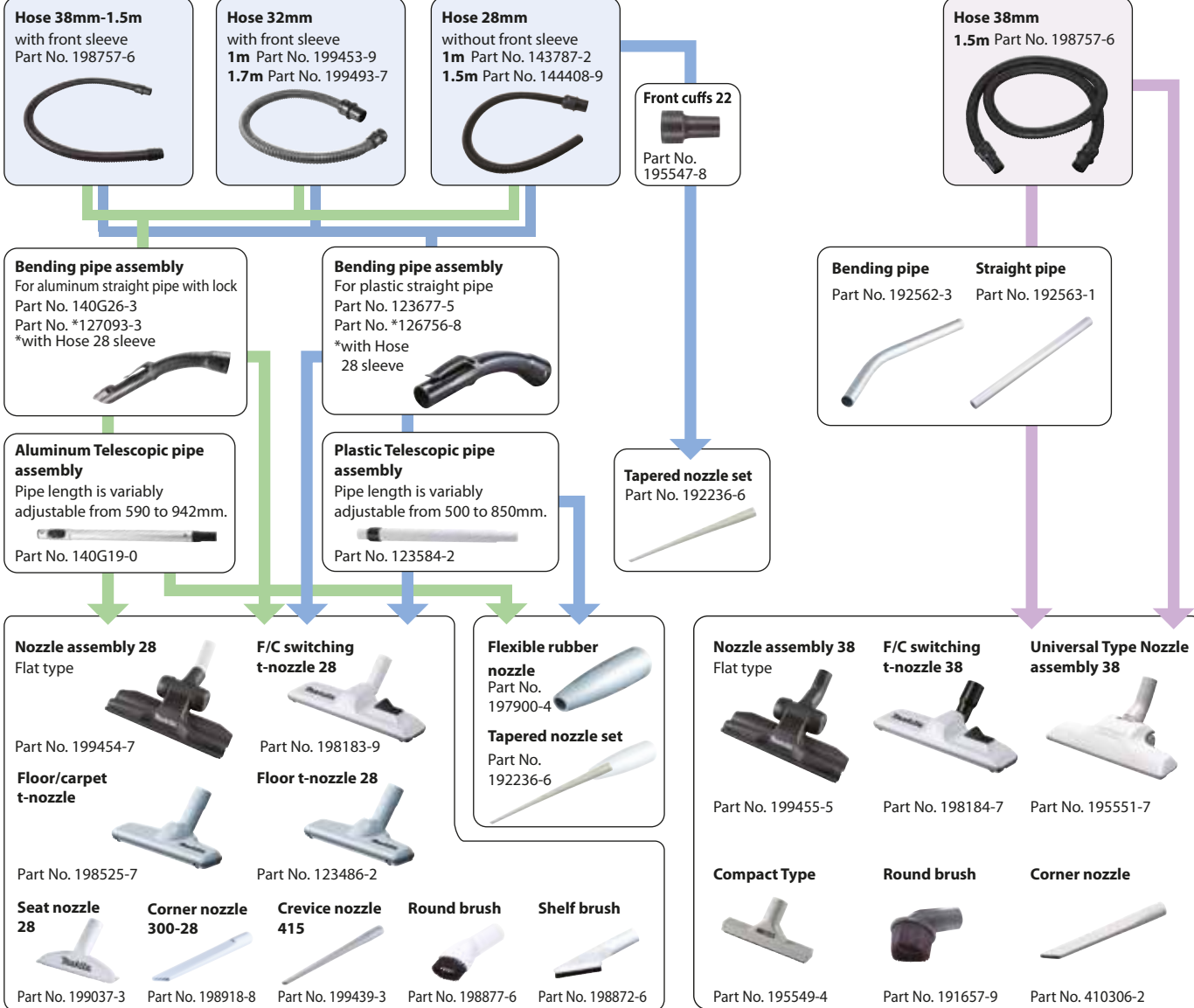

Cordless Backpack Vacuum Cleaner	
DVC261 / DVC265	
Electronic 3-Speed (DVC261)	<b>Capacity</b> Paper dust bag : 2.0 Cloth dust bag : 1.5 L
Electronic 2-Speed (DVC265)	<b>Continuous Use (min.)</b> DVC261 : w/ BL1860B (Max / High / Normal) : 40 / 75 / 140 DVC265 : w/ BL1860B (High / Normal) : 40 / 75
Static Free Hose	<b>Max Air volume</b> w/ Hose Complete 28-1.5 : 1.8 m <sup>3</sup> /min w/ Hose Complete 28-1.0 : 2.0 m <sup>3</sup> /min
Built-in Job Light (DVC261)	<b>Max Sealed Suction</b> 11 kPa
	<b>Suction Power</b> DVC261 : Max / High / Normal w/ Hose 28-1.5 : 85 / 45 / 25 W DVC265 : High / Normal w/ Hose 28-1.5 : 85 / 45 W Operation w/o Load: 2.5 m/s <sup>2</sup> or less
	<b>Vibration Level</b> 70 dB(A) or less
	<b>Sound Pressure Level</b> 230x152x373 mm (9"x6"x14-3/4")
	<b>Dimensions (L x W x H)</b> DVC261 : 3.8 - 4.5 kg (8.5 - 9.9 lbs.) DVC265 : 3.9 - 4.5 kg (8.6 - 10.0 lbs.)
	<b>Net weight</b>
<b>Standard Equipment :</b>	
DVC261 : Floor Nozzle, Hose, Hose Band, Nozzle assembly, Telescopic pipe assembly, Bent Pipe, Switching nozzle, Free Nozzle, Dust Bag, Front Cuffs (22, 24), Battery, Charger	
DVC265 : Hose, Hose Band, Nozzle assembly, Telescopic pipe assembly, Bent Pipe, Switching nozzle, Free Nozzle, Dust Bag, Front Cuffs (22, 24), Wireless Unit, Battery, Charger	

**Makita Singapore Pte Ltd**  
 7, Changi South Street 3, Singapore 486348  
 Phone : +65-6546-8700 Fax : +65-6546-8711  
 Email : msgproductteam@makita.com.sg  
 Website : www.makita.com.sg  
 Facebook : www.facebook.com/MakitaSG



MakitaSG



VISIT OUR WEBSITE

PRINTED IN SINGAPORE



<p><b>Max Air Flow</b></p> <p><b>2.0 m<sup>3</sup>/min</b></p> <p>Model : DVC261 Hose : 28mm - 1.0m</p>	<p><b>Max Sealed Suction</b></p> <p><b>11 kPa</b></p>
---	---







## For Cleaning DVC261



## For Dust Collecting DVC265

### HEPA filter

Exhaust air is as clean as that of air cleaner.



HEPA Filter is used as the main filter to capture very fine particles effectively.

**Able to capture 99.97% of particles as small as 0.3-1 $\mu$ m**

### Controller DVC261



### DVC265

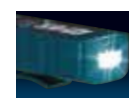

OFF switch  
Max / High / Normal power selection  
High / Normal power selection  
ON-OFF switch for LED job light

LED job light (DVC261 only) convenient for operation in dark job sites

**AWS**  
(DVC265 only)

### **AWS** Auto-start Wireless System DVC265 only

The wireless activation function enables clean and comfortable operation. By connecting a supported tool to the cleaner, you can run the cleaner automatically along with the switch operation of the tool.



wireless unit

**Bluetooth** AWS connects to power tool with Bluetooth  
The Bluetooth® word mark and logos are registered trademarks owned by the Bluetooth SIG, Inc. and any use of such marks by Makita is under license. Other trademarks and trade names are those of their respective owners.

### Expanding AWS Line-up



### For Dust Collecting

**Hose 28mm**  
Length (m) Part No.  
1.0m — 143787-2  
1.5m — 144408-9  
1.5m — A-34235\*

\*with Front cuffs 22 and 38

Supplied with Front cuffs 22, 24 and 38



### Aluminum pipe

common in the building maintenance market



**Pipe lock system** prevents the pipe unintentionally coming off.

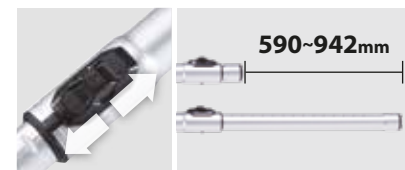

590~942mm

**Telescopic straight pipe** Pipe length is adjustable to user's height simply by sliding a button.

### Floor nozzle



**Thinly made wide flat nozzle** allows to clean in tight spaces e.g. under furnitures.



**Hair removing brush** scrapes out and vacuums up hair/debris on carpet.

### Attachments

